

STEELMAN STEM ORDER FORM

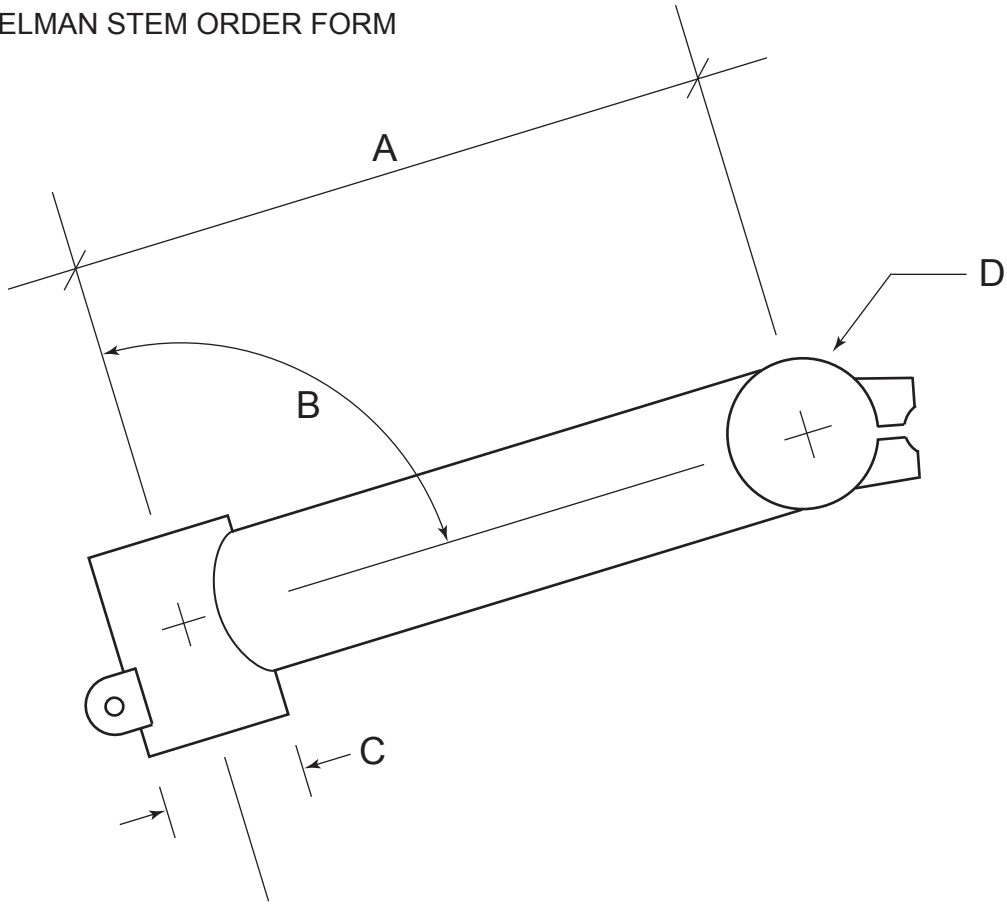

A _____ stem length or extension measured center to center in cm or mm

B _____ angle of rise or fall from 90° (0°) on the fork steerer tube axis

C steerer tube clamp diameter: 1" (25.4mm) 1 1/8" (28.6mm)

D handlebar clamp diameter: 25.4mm (track/mtb) 26.0mm (traditional road)

E stem type: threadless quill (traditional road or track only)

F intended use: _____

G color: raw paint _____

NAME _____

ADDRESS _____

PHONE _____

EMAIL _____